

Stage 1

Type of course
Targets

Number of rounds
to be scored

Start position

Gun condition

Start

Procedure

Medium

2 IPSC Poppers, 6 IPSC targets, 5 IPSC minitargets,
some NS

24

Standing in area A

Gun is loaded and holstered

Audible

After start signal engage all the targets from designated
area

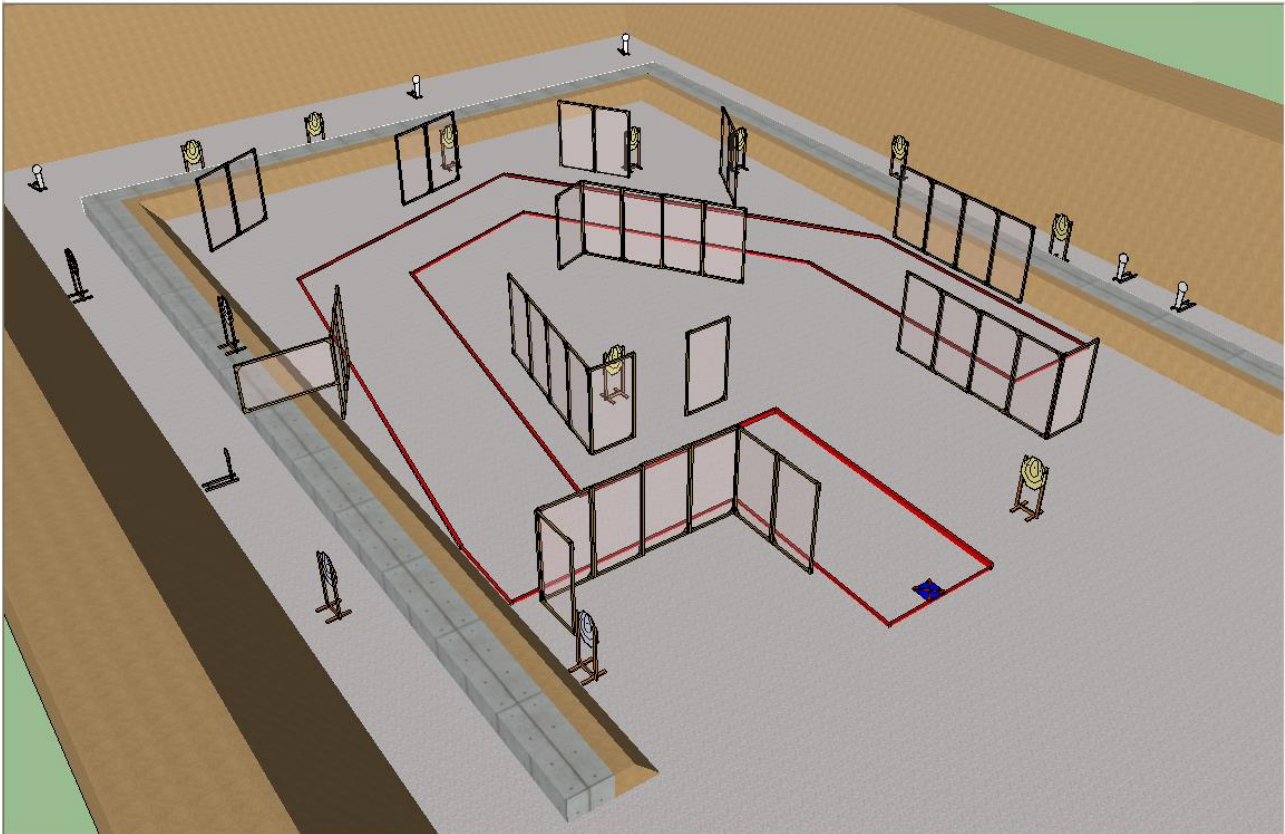

stage 2

Type of course

Targets

Number of rounds
to be scored

Start position

Gun condition

Start

Procedure

Long

6 IPSC Poppers, 13 IPSC targets, some NS

32

Standing at marks

Gun is loaded and holstered

Audible

After start signal engage all the targets from designated
area

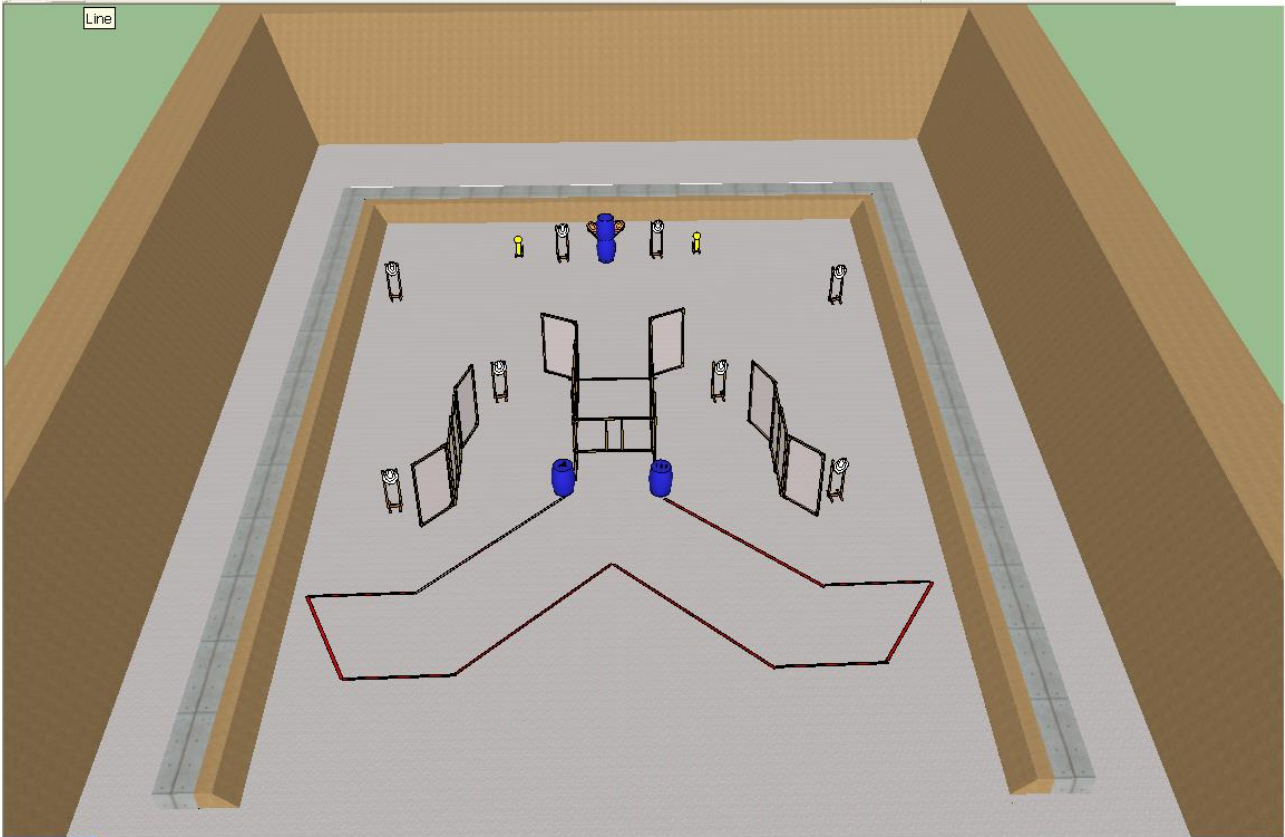

stage 3

Type of course

Targets

Number of rounds
to be scored

Start position

Gun condition

Start

Procedure

Medium

2 IPSC Poppers, 10 IPSC targets, some NS

22

Standing in area A

Gun is unloaded and holstered, chamber empty

Audible

After start signal engage all the targets from designated area. Popper 1 or 2 activate moving targets. All moving targets stays visible at the end of their movement.

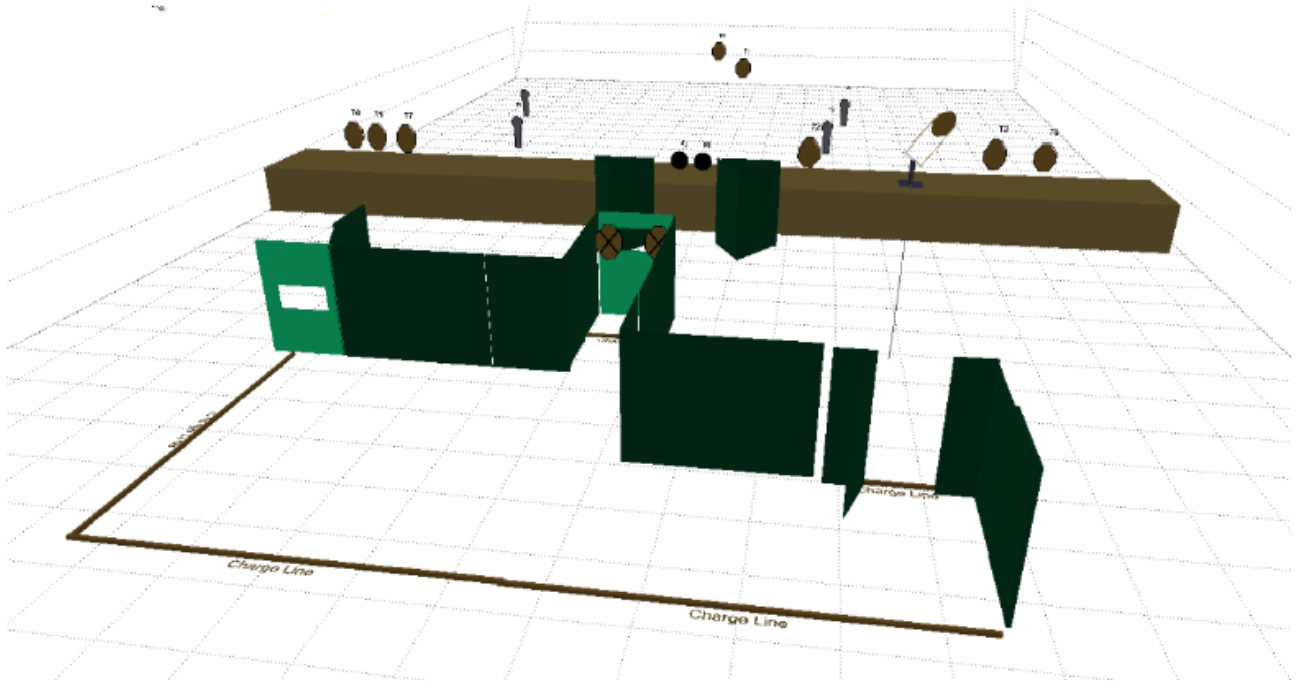

Stage 4

Type of course

Targets

Number of rounds
to be scored

Start position

Gun condition

Start

Procedure

Medium

12 IPSC targets, some NS

24

Standing at marks

Gun is loaded and holstered

Audible

After start signal engage all the targets from designated area. Door activate moving targets. All moving targets stays visible at the end of their movement

(huom kuvasta poiketen ei ole poppereita stagella, niiden tilalla tauluja)

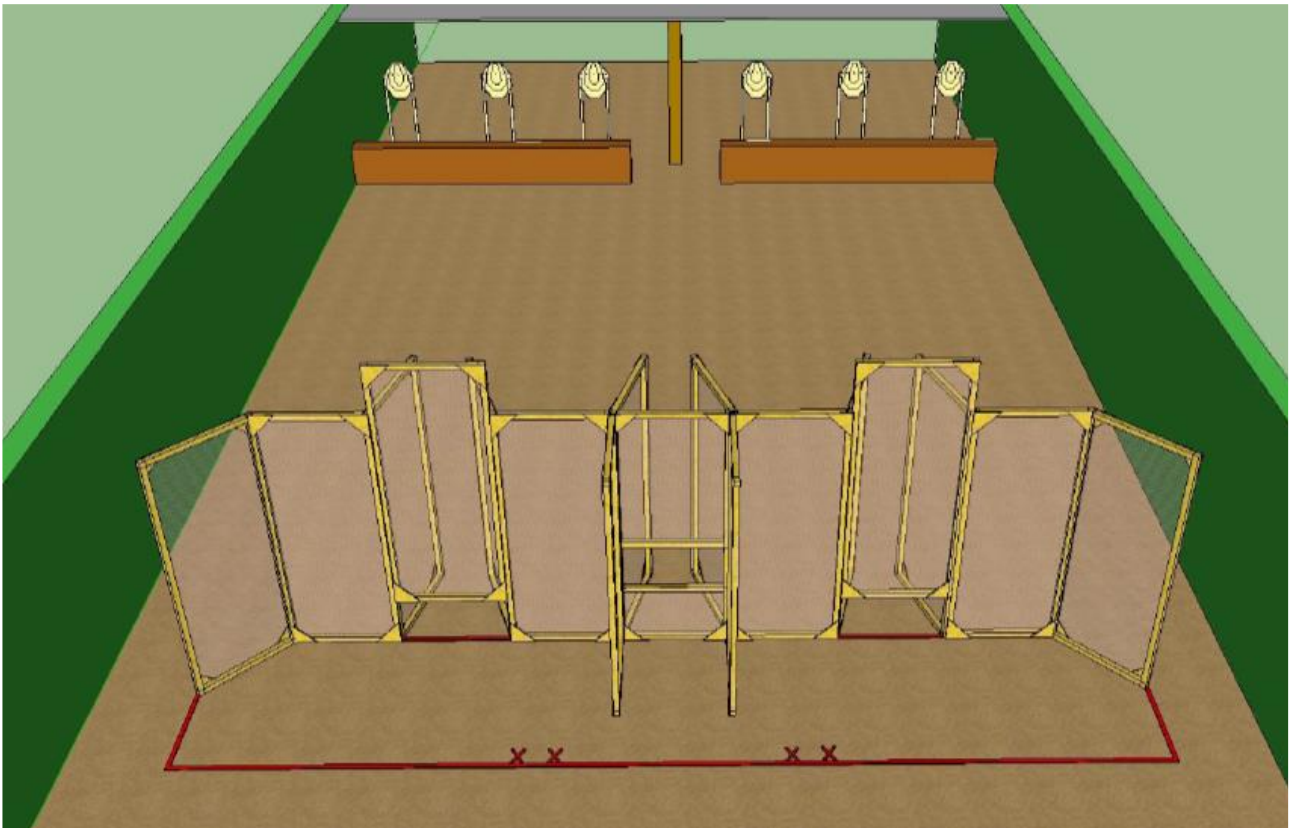

Stage 5

Type of course

Targets

Number of rounds
to be scored

Start position

Gun condition

Start

Procedure

Short

6 IPSC targets

12

Standing at marks

Gun is loaded and holstered

Audible

After start signal engage all the targets from designated
area

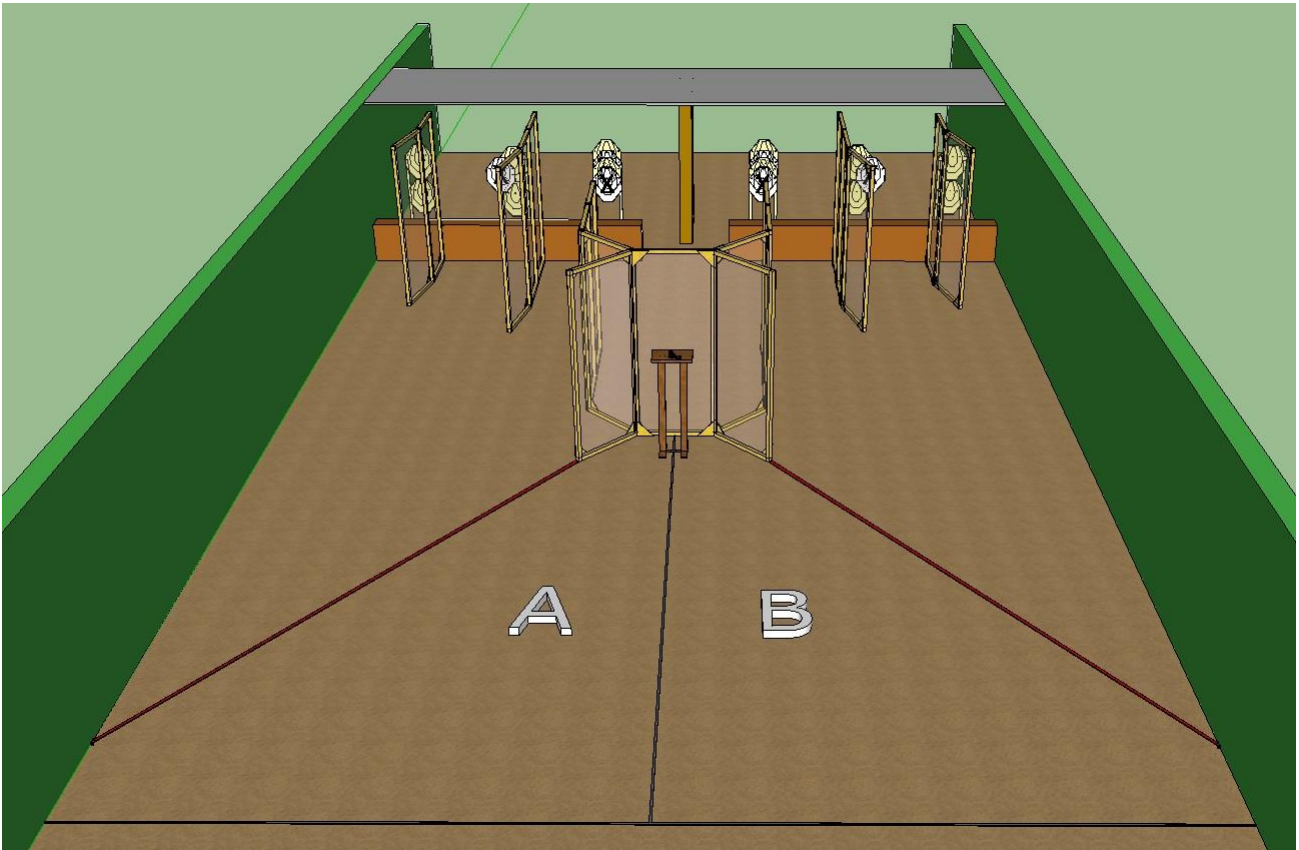

Stage 6

Type of course

Targets

Number of rounds
to be scored

Start position

Gun condition

Start

Procedure

Short

10 IPSC targets, some NS

10

Standing at marks

Gun is loaded on the table, magazines on belt

Audible

After start signal engage all the targets from designated area A or B. Weak/strong hand only. If use strong hand in area A , must use weak hand area B, or or the opposite way.

Mandatory reload before first shot while changing area A to B, or B to A.

One shot per target

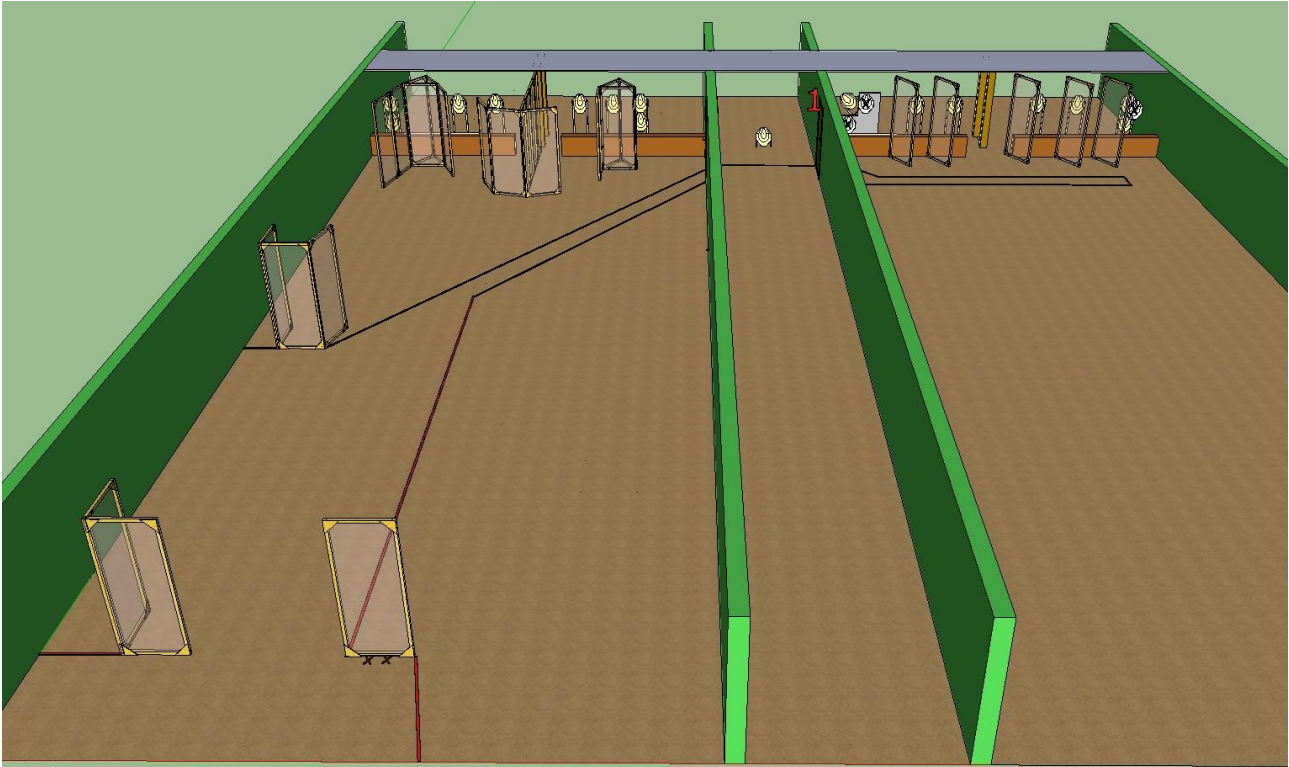

Stage 7

Type of course

Long

Targets

16 IPSC targets, some NS

Number of rounds
to be scored

32

Start position

Standing at marks

Gun condition

Gun is loaded and holstered,

Start

Audible

Procedure

After start signal engage all the targets from designated area. Door 1 activate moving targets. All moving targets stays visible at the end of their movement